

HORIZONTAL LAMINAR FLOW CABINETS

Work station providing better than ISO 5 and EC GMP Grade A air quality. Flow of air is unidirectional and towards the operator to ensure clean 'first air' in working zone

HLF RANGE



Illustrated: HLF 6B in stainless steel on optional Vari-Height stand

APPLICATIONS

- Hospital pharmacy operations such as preparing TPN and IV bags.
- Laboratory plant tissue work where sterility of the work is essential.
- Pharmaceutical handling of powders or liquids where sterility is required and the operation presents no hazard to the operator.
- Assembly/manufacture of micro-electronics components.
- Precise mechanical assembly of inertial platforms, hard disc drives etc.

FEATURES

- Unidirectional air flow
- Variable speed super silent fans
- Helps clean up room air
- No effect on room pressures
- Easy to install
- Available on a mobile frame for convenient movement
- Sterile air conditions within minutes of starting
- DOP Test Port
- Inexpensive to purchase and to operate
- Clear Side Screens

OPTIONS

- Filter pressure differential gauge
- Digital airflow meter
- 316L stainless steel work surface (standard on mild steel and stainless steel units)
- ULPA Filters
- UV Lights
- Table frame with lockable castors or levelling feet
- Vari-Height stand (illustrated)
- Service Taps (i.e. Vacuum, Compressed Air, etc).
- Electrical Sockets

MODEL	A mm	B mm	C mm	D mm	Air Volume handled m³/h (cfm)	Approx Weight kg	Power UK kw	FLC Amps
HLF3B	970	895	590	1100	918 (540)	118	1.44	6
HLF4B	1270	1200	590	1100	1224 (720)	135	1.44	6
HLF5B	1580	1500	590	1100	1530 (900)	147	1.44	6
HLF6B	1880	1800	590	1100	1836 (1080)	216	2.64	11
HLF3BE	970	895	742	1252	1148 (675)	135	1.44	6
HLF4BE	1270	1200	742	1252	1530 (900)	155	2.64	11
HLF5BE	1580	1500	742	1252	1913 (1125)	187	2.64	11
HLF6BE	1880	1800	742	1252	2295 (1350)	235	2.64	11

- Laminar flow cabinets and enclosures*
- Microbiological safety cabinets*
- Isolators*
- Downflow booths*
- Fume cupboards*
- Bespoke equipment*
- Clean rooms*
- Containment suites*
- Facility design, build and installation*
- Service and testing*
- Spares and consumables*
- Commissioning*
- Validation*
- Training*
- Regulatory Advice*
- Purchase, rent or lease solutions*

MATERIALS OF CONSTRUCTION

The HLF range can be specified in the following materials of construction:-

- High quality white laminated mineral board
- White polyester painted mild steel
- Stainless steel

STANDARDS COMPLIANCE

- BS EN ISO 14644 Class 3, 4 or 5 depending on main filter
- EC GMP Class A

LIGHTING

- Min 500 Lux at working level.

ELECTRICAL SUPPLY

- 220/240V single phase or any other international requirement.

INSTRUMENTATION & CONTROLS

- Fans on/off switch/indicator
- Lights on/off switch
- Solid state fan speed controller

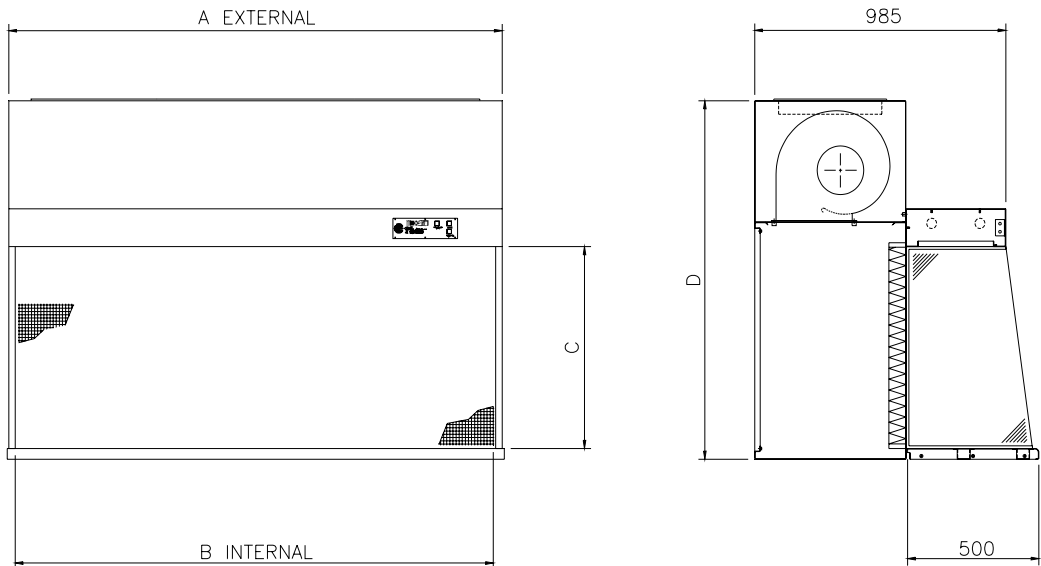

We reserve the right to change any part of this brochure, product or service information, or this legal notice at any time without notice. Any third party or third party products referred to or featured should not in any way be taken as a recommendation or an endorsement of the third party or the third party product. Whilst reasonable care has been taken in compiling this brochure, it may include inaccuracies or typographical errors.